



To learn about other Suncast products, please call
1-800-846-2345 or 1-630-879-2050.



Product Feedback? Go To: Suncastcommercial.com/feedback
OR email us at: feedback@suncastcommercial.com

ITEM NUMBER: TTTOWRACKHD

PARTS

Standard Duty/Heavy Duty Tow Rack

To be used with Standard or Heavy Duty Tilt Truck

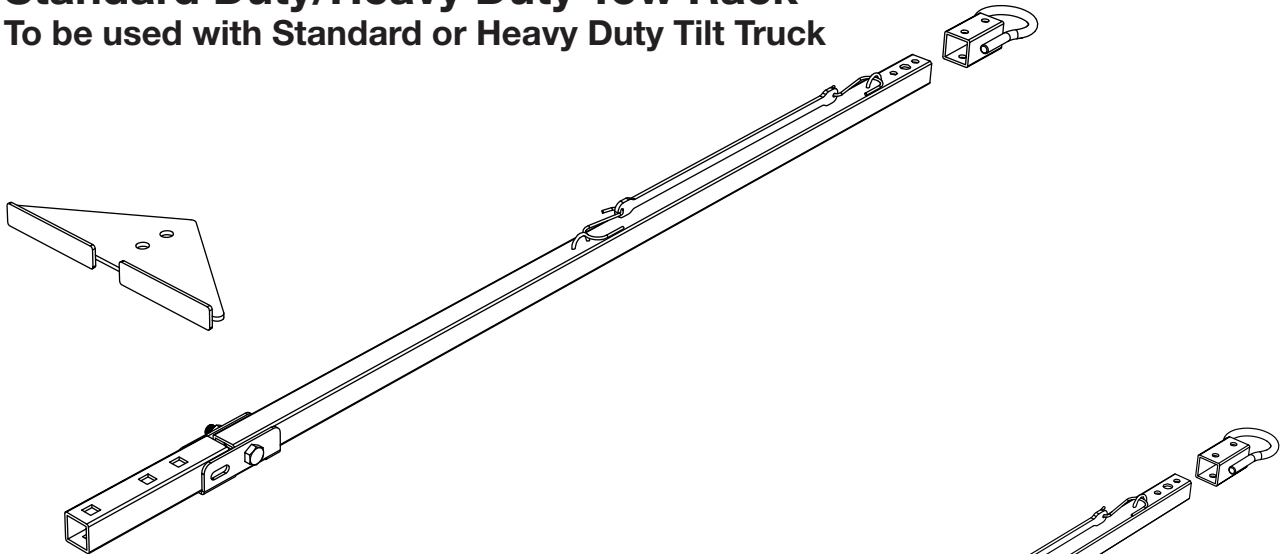

Light Duty Tow Rack

To be used with Light Duty Tilt Truck

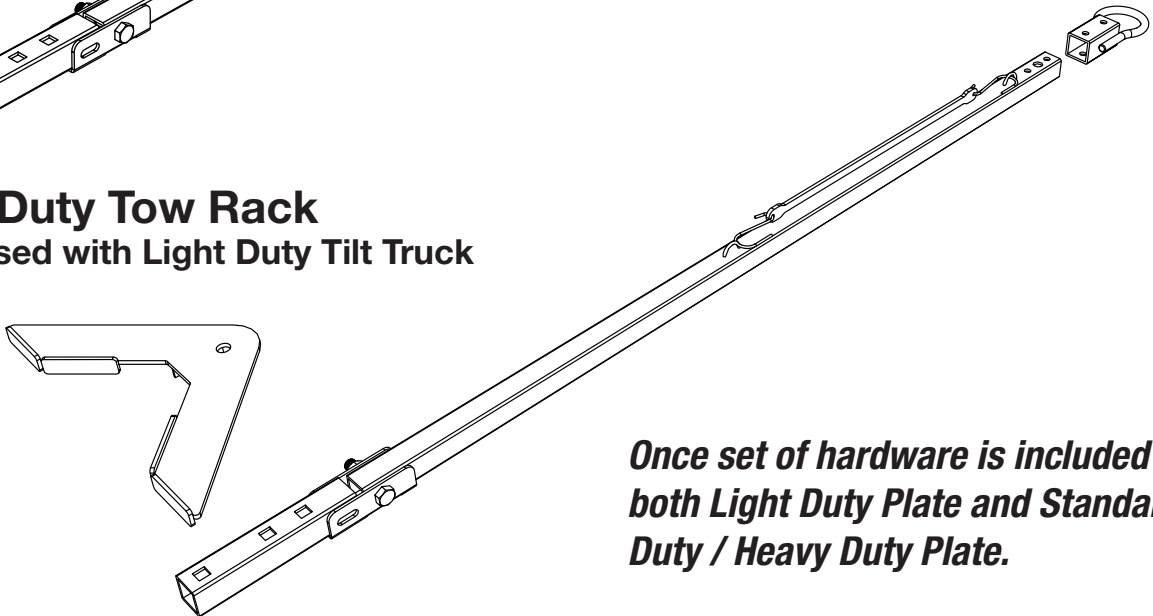

***Once set of hardware is included for
both Light Duty Plate and Standard
Duty / Heavy Duty Plate.***

TOOLS NEEDED

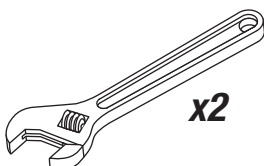

x2

HARDWARE

* Standard / Heavy Duty / Light Duty Hardware (Pgs. 2 and 3)

Tow Rack to Tilt Truck Hardware (Pg. 3 top)

Hitch Attachment Hardware (Pg.4)

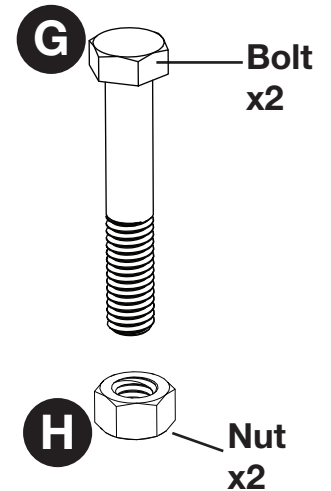
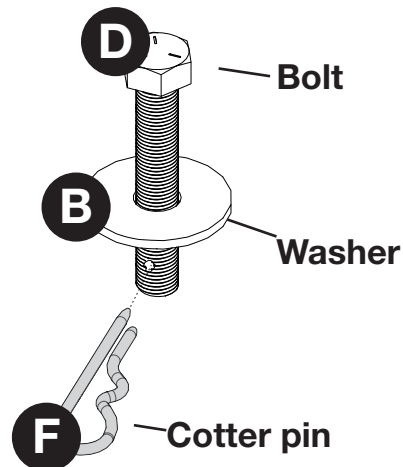
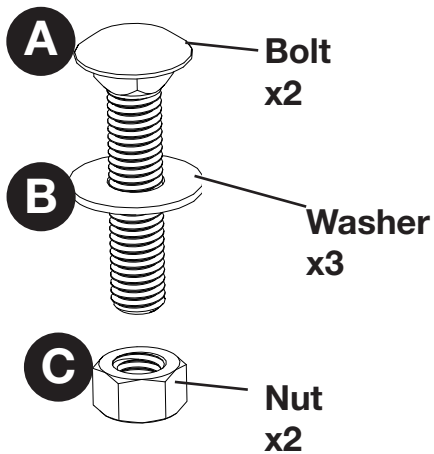

*How to attach Tow Rack to Standard Duty/Heavy Duty Tilt Truck:

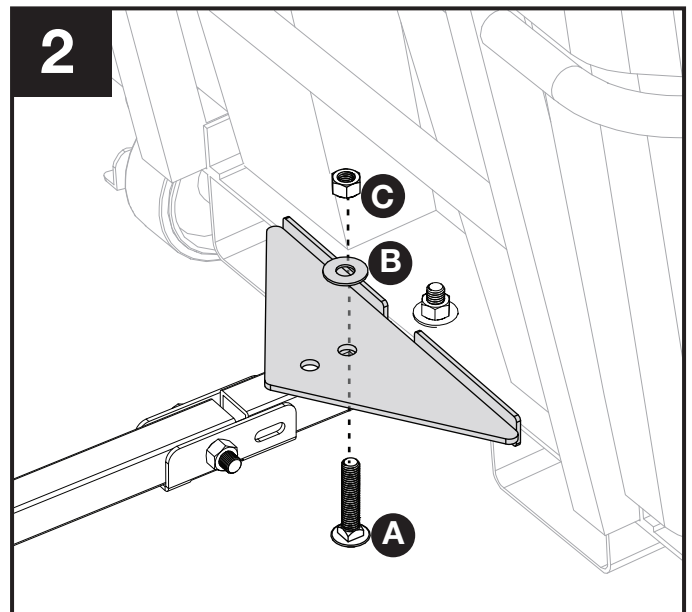
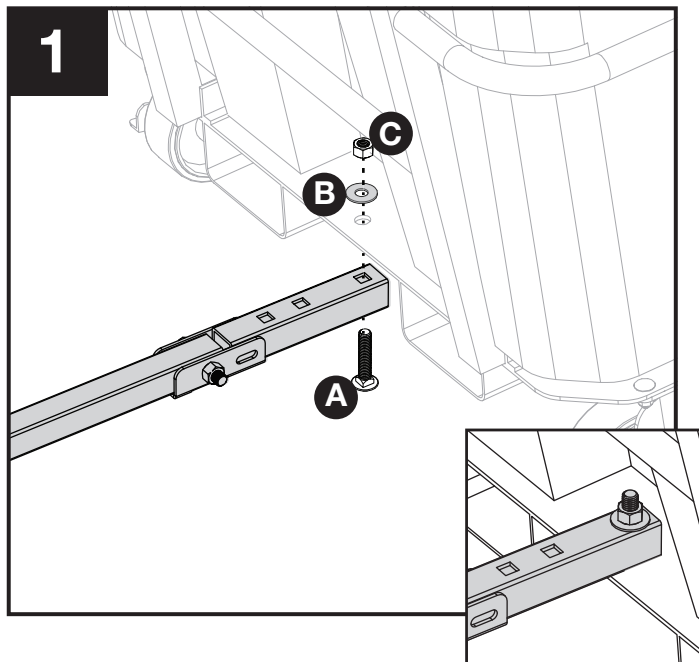

Attach bar to Tilt Truck using one bolt (A), one washer (B) and one nut (C).

Attach triangle plate to bar using one bolt (A), one washer (B), and one nut (C).

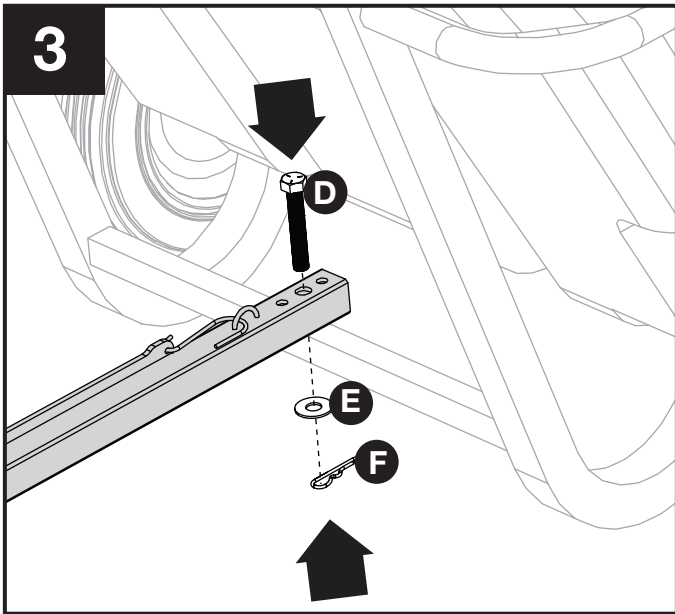

Attach other end of standard tow rack to another tilt truck using the end without the bracket sleeve as shown here. Attach using one bolt (D), one washer (E), and one cotter pin (F).

***How to attach Light Duty Tow Rack to a Light Duty Tilt Truck:**

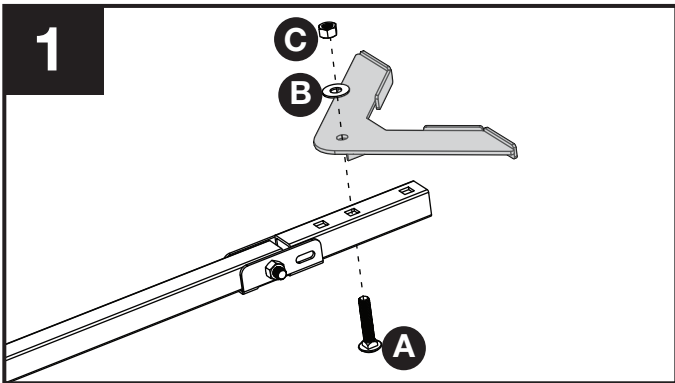

Attach Light Duty bracket to bar using one bolt (A) , one washer (B), and one nut (C).

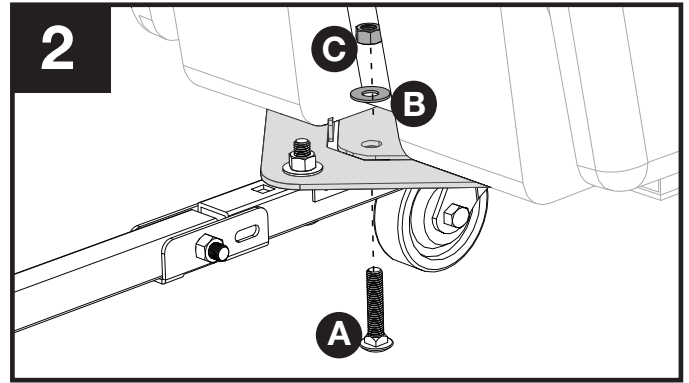

Attach bar with bracket to Light Duty Tilt Truck using one bolt (A), one washer (B) and one nut (C) .

How to attach Tow Rack to a Fork Lift / Ball Hitch

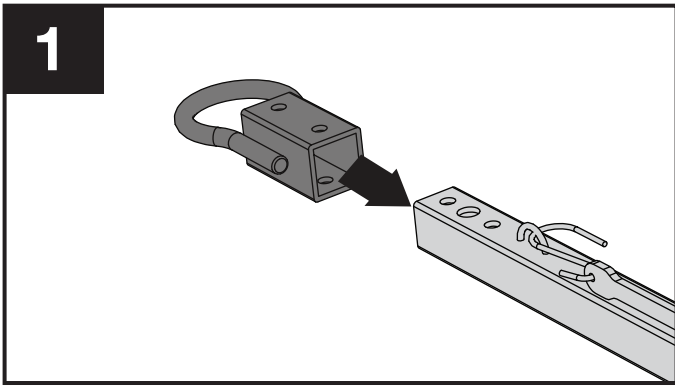

Slip bracket over bar.

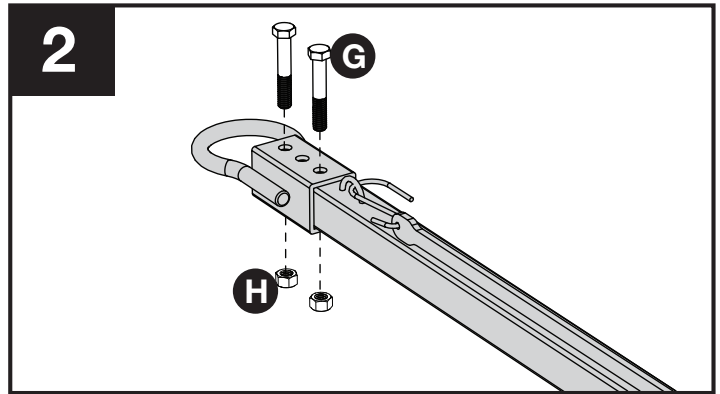

Attach bracket using two bolts (G) and two nuts (H).

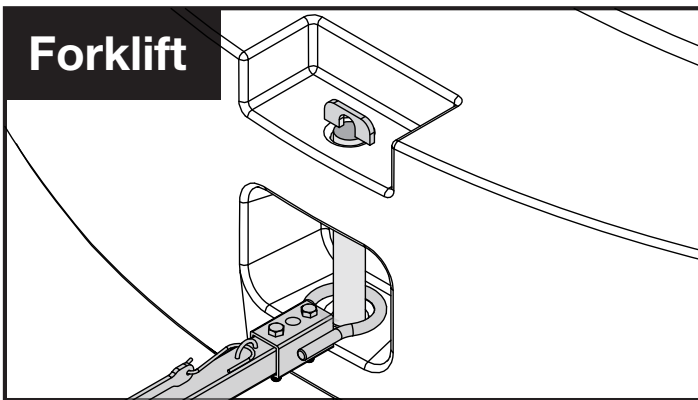

Forklift shown in this step uses a pin style attachment method. Consult the fork lift manufacturer's product manual for proper attachment. Suncoast Commercial is not responsible for improper attachment or materials not included for proper assembly to Forklift.

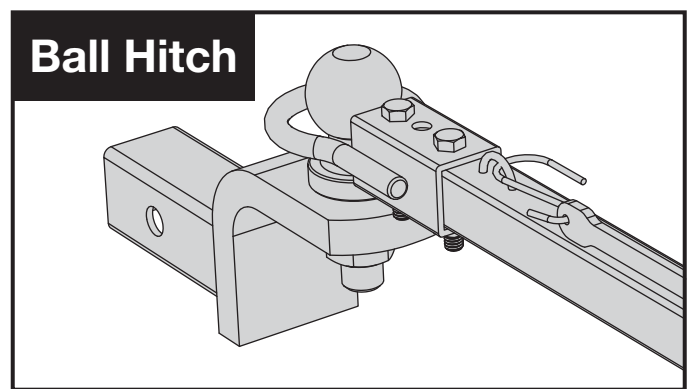

Ball hitch attachment as shown. Suncoast Commercial is not responsible for improper attachment or materials not included for proper assembly to Ball Hitch.



! It is recommended to hitch a maximum of two to three tilt trucks together, depending on aisle size. Use caution if attaching additional tilt trucks.

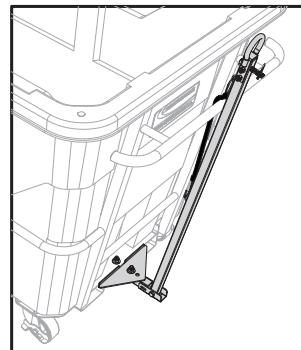

When not in use, move tow rack to a vertical position. Un-hook bungee cord from top of tow rack and run underneath handle to attach back onto tow rack. Bungee should be in a vertical position.